

CERTIFIED RECORD OF LAND CORNER MONUMENTATION

36

U

History of original corner establishment:

None

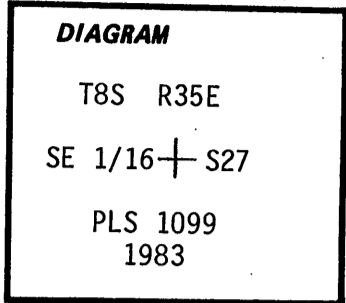

Description of corner evidence found:

None

Description of monument and accessories established to perpetuate the original location of this corner:

At CORNER POSITION, determined by survey set 2 1/2"x30" galvanized iron pipe with brass cap 27" in ground with raised mound of stone marked: T8S R35E

From Which:
A Ponderosa Pine 16" dia. bears N 4° W, 93.6 ft. marked SE 1/16 SE 1/16 + S27 S27 BT.

A Ponderosa Pine 18" dia. bears N 87°E, 173.7 ft. marked SE 1/16 PLS 1099 S27 BT. 1983

Attached brass washers stamped LS 1099 to BT blaze on both trees.

Corner location perpetuated in accordance with Umatilla N.F. survey contract No. 53-04R3-2-01275.

20°E Declination
Steel Tape

Post 5'+ South
Post 5'+ West

August 31, 1983

Witnesses: A. Ray Crapo
Greg Orton
Kyle McKinney

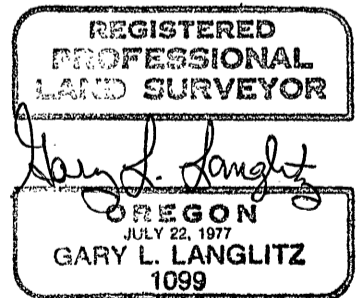

Corner falls along side road approx. 150' from Jct. with Squaw Creek Rd.
Refer to Grant County Survey No. 828

Office of SURVEYOR County of GRANT
 State of OREGON, I hereby certify that the within instrument was filed in this office
 for record on the 30 day of AUG., 1984
Robert D. Dyer by _____
 (COUNTY OFFICIAL) (DEPUTY)